



## Code Compliance Research Report

## CCRR-0152

Subject to Renewal: 02/23/2011  
Visit [www.archtest.com](http://www.archtest.com) for current status

Issued: 02/23/2010  
Revised: 03/01/2010  
Page 1 of 3

**Fiber Composites, LLC**  
181 Random Drive  
New London, North Carolina 28127  
(704) 463-2921

**Additional Listee:**  
**CertainTeed Corporation**  
231 Ship Canal Parkway  
Buffalo, New York 14218  
(517) 780-3185

### 1.0 Subject

#### Fiber Composites Deck Boards:

Fiberon® Sensibuilt™ Decking  
Veranda Sanctuary Extreme  
Fiberon® Outdoor Flooring™

#### CertainTeed Corporation Deck Boards:

CertainTeed EverNew LT

### 2.0 Research Scope

#### 2.1. Building Codes:

2009 International Building Code (IBC)  
2009 International Residential Code (IRC)  
2007 Florida Building Code (FBC)

#### 2.2. Properties:

Structural Performance  
Durability  
Surface Burning  
Decay Resistance  
Termite Resistance

### 3.0 Description

3.1. General – Deck boards recognized in this report are intended for use as a walking surface on exterior decks, balconies, porches, and walkways, including stairs as further defined herein.

3.2. Materials and Processes – Deck boards are extruded cellular PolyVinyl Chloride (PVC) with a patented Lumenite™ coating.

3.3. Finished deck boards have a solid rectangular profile with nominal dimensions of 5.5 inches wide and 1.0 inch thick. Edges are rounded with a 0.125 inch radius. See Figure 1.

3.4. Deck boards have an embossed walking surface (simulated wood grain) and may be manufactured in the following colors: Driftwood, Redwood, Cedar and Mocha.

3.5. Deck boards may be installed face-fastened using bugle-head deck screws or by using trim-head deck screws installed with the "Deck Pilot"™ hidden fastener installation system.

### 4.0 Performance Characteristics

4.1. All deck boards are rated for a uniform live load of 100 lbs/ft.<sup>2</sup> when installed on support framing spaced 16 inches on center.

4.2. Deck boards used as stair treads are rated for the code-required concentrated load equal to 300 lbs when installed as a continuous deck board over a minimum of three supports with a maximum 17.25 inch support span when installed in accordance with Figure 2.

4.3. Deck boards have a wind uplift resistance rating equal to 211 lbs/ft.<sup>2</sup> when installed on support framing spaced 16 inches on center in accordance with Section 5.1 or 5.2.

4.4. Deck boards have a flame spread index of 20 when tested in accordance with ASTM E 84. The referenced criteria, AC174, requires a flame spread index not exceeding 200.

4.5. Deck boards are deemed equivalent to preservative treated or naturally durable wood for resistance to weathering effects, attack from termites and fungus decay.

4.6. Structural performance has been demonstrated for a temperature range from -20°F to +125°F.

### 5.0 Installation

Installation shall be in accordance with the manufacturer's installation instructions and this report. Where differences occur between this report and the manufacturer's installation instructions, this report shall govern.



5.1. When face-fastened, deck boards shall be installed with #8 x 2-1/2 inch bugle-head deck screws. Two screws shall be used at every joist and shall be positioned 0.75 inch to 1 inch from board edges.

5.2. When fastened using the "Deck Pilot"™ hidden fastener installation system, deck boards shall be installed using #7 x 1-5/8 inch trim-head deck screws (0.167 thread diameter). Each edge of the deck board is fastened at every joist (two screws per joist) The outboard edges of the first and last deck boards are face-fastened using #7 x 2-1/4 inch trim-head deck screws at every joist.

5.3. Deck boards placed at an angle other than 90 degrees to the supporting joist will require support framing at a reduced spacing such that the span of the deck board does not exceed 16 inches. For deck boards installed at 45 degrees to the support framing, joist spacing shall not exceed 12 inches.

5.4. Deck boards used as stair treads shall be installed in accordance with Figure 2. Support blocking beneath each pair of deck boards shall be 2x6 preservative treated So. Pine installed as shown with Simpson A23Z angle brackets.

## 6.0 Supporting Evidence

6.1. Manufacturer's drawings and installation instructions.

6.2. Reports of testing demonstrating compliance with ICC-ES Acceptance Criteria for Deck Board Span Ratings and Guardrail Systems (Guards and Handrails), AC174 effective June 1, 2009.

6.3. Quality control manual in accordance with ICC-ES Acceptance Criteria for Quality Control Documentation, AC10.

## 7.0 Conditions of Use

The deck board applications identified in this report are deemed to comply with the intent of the provisions of the referenced building codes subject to the following conditions.

7.1. Deck boards are limited to use in Type V-B (5B) construction.

7.2. The wind uplift resistance rating recognized in this report is based on attachment to treated Southern Pine framing (specific gravity, G=0.55). Installation on wood framing with a lesser specific gravity may result in a lower wind uplift rating.

7.3. Compatibility of fasteners with the supporting structure including chemically treated wood is not within the scope of this report.

7.3.1. Where required by the building official, engineering calculations and details shall be provided. The calculations shall verify that the anchorage complies with the building code for the type of framing and condition of the supporting construction.

7.4. All products recognized in this report are manufactured by Fiber Composites in New London, North Carolina in accordance with the manufacturer's approved quality control system with inspections by PFS Corporation (IAS# AA-652).

## 8.0 Identification

Deck boards produced in accordance with this report shall be identified with labeling on the individual deck boards that includes the following information:

8.1. Name and/or trademark of the manufacturer.

8.2. The mark of the independent inspection agency, PFS Corporation (IAS# AA-652).

8.3. The ATI-ES Code Compliance Research Report Number (CCRR-0152)

## 9.0 Code Compliance Research Report Use

9.1. Approval of building products and/or materials can only be granted by a building official having legal authority in the specific jurisdiction where approval is sought.

9.2. Code Compliance Research Reports shall not be used in any manner that implies an endorsement of the product by ATI.

9.3. Reference to the Architectural Testing internet web site address at [www.archtest.com](http://www.archtest.com) is recommended to ascertain the current version and status of this report.

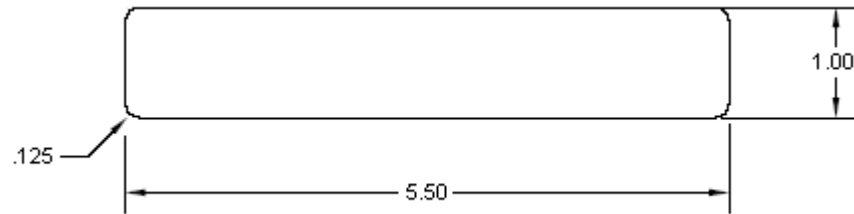
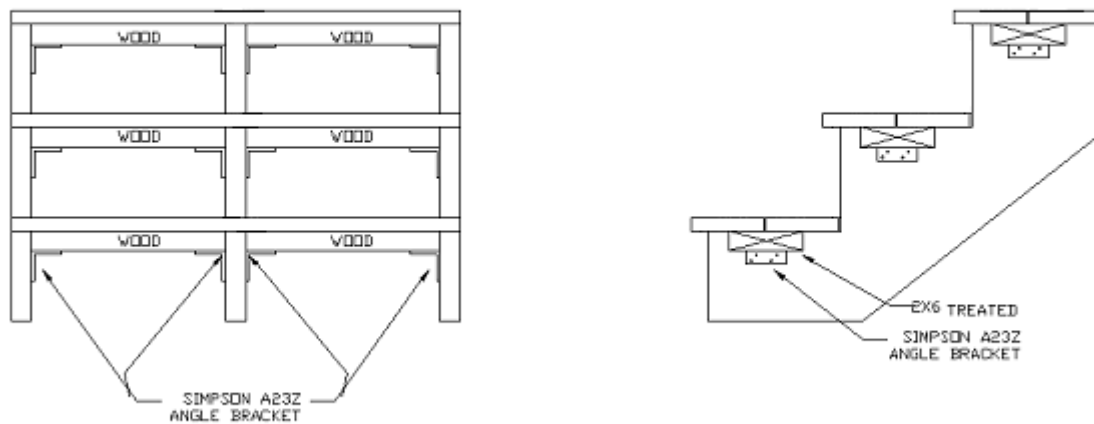
**Figure 1 – Deck Board Profile****Figure 2 – Stair Tread Installation Detail**