

**Important Notice: The Deck Pilot™ hidden fastening system is engineered and tested to be AC-174 compliant for use exclusively with Fiberon PVC branded Decking, screws and accessories. Use of the Deck Pilot System with any other decking materials or fasteners carries a real risk of deck failure and Fiber Composites prohibits all such installations.**

The Fiberon Deck Pilot system provides an exceptionally strong and code compliant hidden fastening system when these simple instructions are followed. Tools needed: Driver drill with adjustable torque settings and a Deck Pilot bit. Proper Fiber Composites PVC Decking installation requires maximum 16" OC joist spacing for perpendicular framing, 12" OC joist spacing for diagonal framing and all commercial applications.

The Deck Pilot Bit is designed to precisely position the screws on both sides of the board without removing the tool. Drive until the flange on the bit just contacts the bushing. When the flange contacts the bushing, **stop driving. Do not overdrive the screw.** Minimize stripping by adjusting the torque on your driver to the lowest setting that fully drives the screws; replace driver bits as they become worn. Do not use "Impact" drivers.

1. Fiber Composites PVC branded decking installs from the outer edge of the deck towards the ledger. Begin by positioning the starting deck board at the outside edge of the deck (away from the house), with a maximum exposed overhang of 1 inch. Face fasten the board along its entire outer edge with minimum #7 x 2-1/4" face screws and not more than 16" on center.
2. Starting with the inside edge, the Deck Pilot tool is designed to create a consistent 3/16" spacing between boards without additional spacers.
3. Using the reference line under the bushing, align the Deck Pilot so the guide line is directly over the center of the joist on 90° applications (Figure A).

Note: On diagonal 30° or 45° applications, align the guide with the outside edge of the joist so that the screw penetrates the joist from the edge toward the center.

4. Fasten boards by advancing from one end to the other and never fasten the middle last. The screw will penetrate the joist and countersink to the correct depth automatically (Figure B).
5. Alternate securing the outside edge first, then the inside edge at each joist before moving tool onward (Figure C).
6. Slide the next board loosely against the previous course allowing room to place the Deck Pilot over the board, then snug it tightly to the previous course.
7. Continue securing each course alternating from the outside to the inside (Figure D).
8. When you reach the house wall, face fasten the last board with minimum #7 x 2-1/4" face screws a maximum of 16" on center.

Note: Stripped screws can be removed with a #2 screw extractor. Spacing guides such as Deck Mate™ or DECKIT™ are commercially available to assist in consistent 3/16" plank spacing. Many contractors make their own spacers. One technique is to cut 6" x 4" pieces of plywood, pre-drill a 1/8" hole, 2" from one end and drive a 20 penny common nail or #10 wood screw (both 3/16" diameter) about half-way, straight through the plywood. Position spacers on the boards no more than two feet from either side of the Deck Pilot and at both ends of the board.



Figure A



Figure B

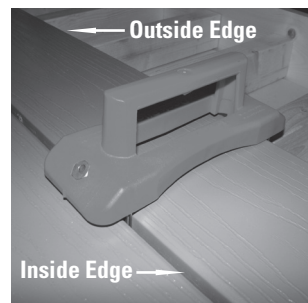

Figure C

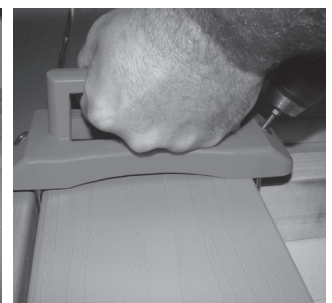

Figure D